

# THE V-SERIES RECESSED \*

## INSTALLATION INSTRUCTIONS

\*Excluding EL-V16103

- + PLEASE READ THIS GUIDE CAREFULLY BEFORE INSTALLING OR MAINTAINING THIS EQUIPMENT.
- + DATA SHOULD BE USED AS AN INDICATION ONLY.
- + GOOD ELECTRICAL PRACTICES SHOULD BE FOLLOWED AT ALL TIMES.
- + MUST ONLY BE INSTALLED BY A LICENSED ELECTRICIAN.
- + IF THE EXTERNAL FLEXIBLE CABLE OR CORD OF THIS LUMINAIRE IS DAMAGED, IT SHALL BE EXCLUSIVELY REPLACED BY THE MANUFACTURER OR HIS SERVICE AGENT OR A SIMILAR QUALIFIED PERSON IN ORDER TO AVOID A HAZARD
- + FOR INDOOR USE ONLY

### THIS GUIDE IS FOR THE FOLLOWING LUMINAIRE MODELS

CUT OUT Ø		CUT OUT Ø	
EL-V16104	70mm	EL-V16201	140mm
EL-V16108	83mm	EL-V16255	83mm
EL-V16154	83mm	EL-V16270	140mm
EL-V16195	105mm	EL-V16285	100mm

### INSTALLATION INSTRUCTIONS

1. Make sure that power to the circuit is OFF.
2. Cut out the correct size hole in the ceiling.
3. Check that the power supply is connected to the luminaire via the bi-pin connector. If not, connect it making sure that connector is clicked into locked position.
4. Wire mains to the terminal block on the power supply observing correct polarity of L (brown) and N (blue). Replace and screw in place the strain relief cover of the power supply (if applicable).
5. Place the power supply into the ceiling.
6. Lift the springs to vertical and insert the luminaire into ceiling cut-out in a controlled manner.
7. Restore power and test installation.

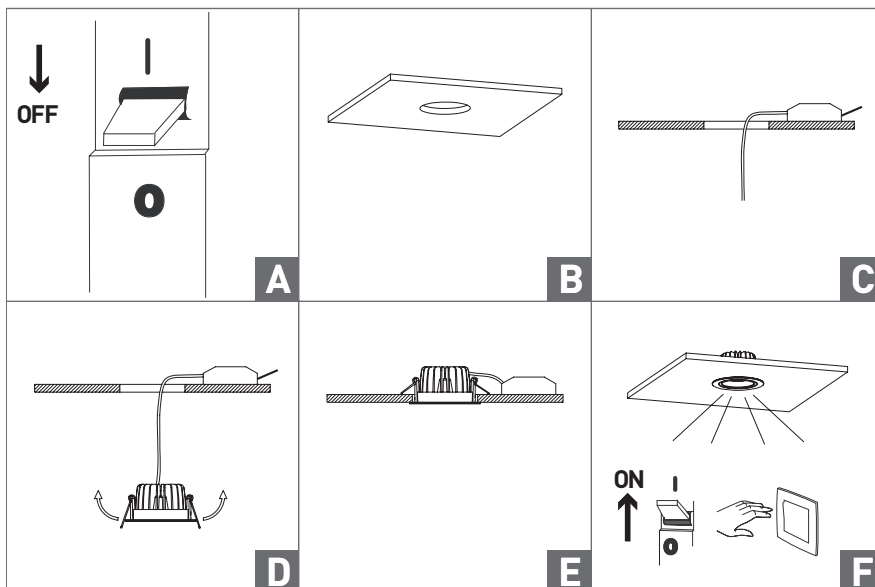

### GENERAL INFORMATION

- A qualified electrician, in accordance with AS/NZS 3000:2007 wiring regulations should carry out connection to mains wiring.
- Ensure that the rated voltage and frequency requirements are compatible with the available mains supply, 220-240V 50Hz
- Cleaning of reflectors and lenses should be carried out using clean, soft and lint free cloths and anti-static cleaning fluid.
- Do not carry out high voltage insulation test i.e. 500/1000V this may damage the fixtures electrical components.

### SPECIFICATION



Luminaire's light distribution is direct.



Denotes which light source/light sources that can be supplied with the luminaire. Several symbols next to the same luminaire indicate that the luminaire is available in different designs.



#### IP classification:

**IIP44/20:** IP44 from below: (in its installed position) Protected against solid objects over 1mm (tools, wires, and small wires). Protection against splashing water from any direction (splash proof) - limited ingress permitted. **IP20 from the rear :** (in its installed position) Protected against solid objects over 12mm (fingers).



**Class 2 :** Double insulated electrical appliances designed in such a way that they do not require a safety connection to ground.



This luminaire is not suitable for covering with thermally insulating material. The minimum clearance required in all directions is 100mm



RCM indicates a device's compliance with applicable ACMA technical standards.

HEAD OFFICE | MELBOURNE  
EAGLE LIGHTING VIC

17-19 Jets Court  
Melbourne Airport VIC 3045  
P 03 9344 7444  
F 03 9344 7433

SYDNEY  
EAGLE LIGHTING NSW

Unit 4, 21 Mars Road  
Lane Cove NSW 2066  
P 02 9420 5799  
F 02 9420 5988

BRISBANE  
EAGLE LIGHTING QLD

53 Caswell Street  
East Brisbane QLD 4169  
P 07 3891 0744  
F 07 3891 0755

CANBERRA  
EAGLE LIGHTING ACT

M 0411 889 406

eaglelightingaustralia  
'Member of the Fagerhult Group'

EAGLE LIGHTING AUSTRALIA PTY LTD  
ABN 46 124 400 933