EnOcean Wall Switch Setup Guide

V1.0, 01/03/2019

Introduction:

Organic Response Lighting Control System can now integrate an EnOcean Wall Switch to provide localized control. The EnOcean Wall Switch Setup Guide is a configuration and reading program in the Organic Response smartphone app for EnOcean Wall Switches. This tool can be used to configure the buttons of the EnOcean Wall Switch for a range of control functions as well as reading the switch's current configuration.

Basic Functions:

- Configuration
- Reading the Current Configuration

List of Configurable Functions:

FUNCTION	OPERATION
On/Auto	Lights revert back to Organic Response auto operating mode
Off	Turn lights off (0% light level)
Dim -	Dim lights down by one dimming level from current
Dim +	Dim lights up by one dimming level from current
Scenes 0 - 6	Set lights to the Scene's light output

Requirements:

In order to make full use of the functionality of the EnOcean Wall Switch Setup program, the following are required:

- Android device with a Near Field Communication (NFC) interface
- Organic Response Smartphone app with Configurator Level Access
- EnOcean Wall Switch

Notes!

- The NFC Interface allows wireless communication to write and read configuration. However, pop-up errors can occur during the configuration or reading process such as 'Incorrect ID' or 'Tag Lost'. This error arises due to incorrect alignment of your smartphone with EnOcean Wall Switch. A correct communication between the switch and the android device can only be guaranteed if the android phone is placed very close or even directly on the switch. Any material placed between the switch and the android phone can cause a deterioration of the communication quality. We recommend that the android phone is placed near the switch with its back upright facing directly to the switch such that the NFC interface in the android device and the switch become aligned. You may require adjusting by moving phone while performing read or configuration.
- Please refer to the "Using the Organic Response App" which is available at the Organic Response website (www.organicresponse.com) on how to download and use the Organic Response App.

Compatible EnOcean Wall Switch Devices:

The compatible EnOcean Wall Switches which are configurable by the program are tested for Easyfit series which comes in a Single Rocker (2 Buttons Switch) and the Double Rocker (4 Buttons Switch).



Manufacturer	Easyfit by EnOcean
Product Name	Easyfit Single / Double Rocker Wall Switch for BLE – EWSSB / EWDSB
Label Information	<p>In order to ensure compatibility, see the highlighted versioning system on EnOcean Wall Switch module labeling as below;</p>  <p>DB-02 is version number. – Any versions higher than DB-02 will be compatible with SN3. (e.g. DB-03, DC-01 etc. are all compatible) (Preferred method to check compatibility) 06/19 is (week/year) of the manufacture – Any manufacture from year 2019 i.e. 01/19 onwards will be compatible with SN3.</p> <p>Please contact ORT if unsure at any stage.</p>

Configuration:

Notes!

- The EnOcean Wall Switch Setup program can be accessed through updated (1.6.2 or higher) Android version of Organic Response App once logged in as configurator. Tap the 3-bar menu icon in the upper right-hand corner -> Scrolling down to select 'EnOcean Wall Switch Setup'
- The graphic buttons correspond to the physical layout of the switch. For 4 Button Switches, buttons 1 and 2 map to the left rocker pad, and buttons 3 and 4 to the right rocker pad. For 2-button switches, you can only use buttons 1 and 2 and the graphic would toggle automatically.

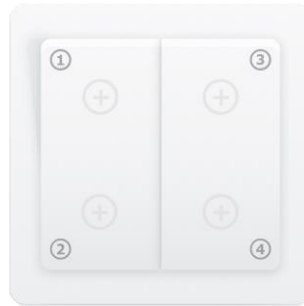

- Each button displays the functionality once assigned to it. Selecting the 2 Buttons Switch, the app displays only a Single Rocker Pad. Selecting the 4 Buttons Switch, it displays the Double Rocker Pads. The Zone identifies the zone of lights that the Wall Switch controls. If no zones are selected, the switch will control 'Any' zone.
- For the ON/AUTO functionality, a momentary press of the button on the wall switch results in an ON/AUTO message being sent to the nodes. A long-held press, however, sends DIM UP (+) messages for 5 sec and then stops dimming. To continue dimming hold repeat the long-held press. Likewise, with the OFF functionality, a momentary press sends an OFF message and a long-held press sends DIM DOWN (-) messages for 5 sec & then stops dimming. To continue dimming hold repeat the long-held press.
- The Organic Response IR Dongle is not required for this procedure and connecting the IR Dongle or any other device to the audio port of the Android phone will disable the sound notifications associated with 'ENOCOAN WALL SWITCH SETUP' page.

Procedure:

1. With the 'EnOcean Wall Switch Setup' page, select 2 Buttons or 4 Buttons depending on the wall switch being configured.

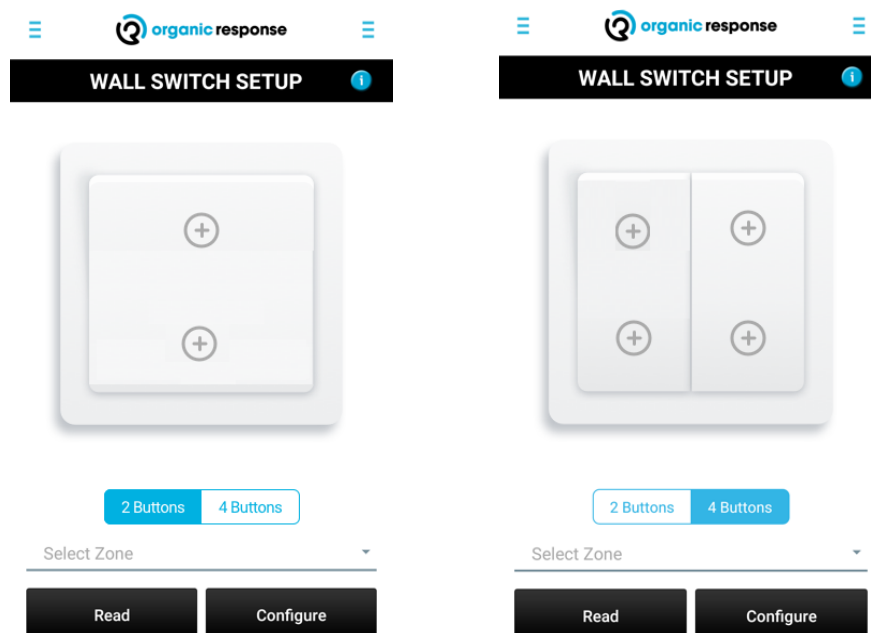

- Select the function to assign to each button. The available functions are displayed by pressing the '+' sign on each button. Each button offers the same set of available functionalities. To change the existing function of a button, press the assigned function.

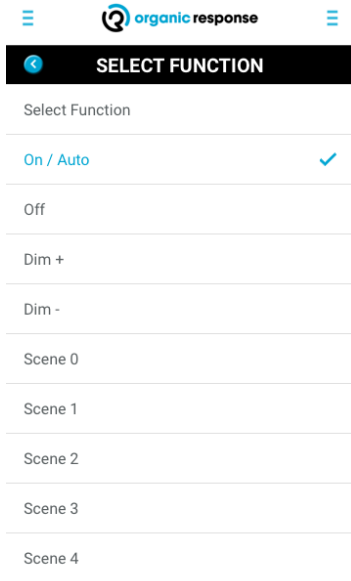

- Select the Zone by pressing the down arrow and selecting the desired zone.

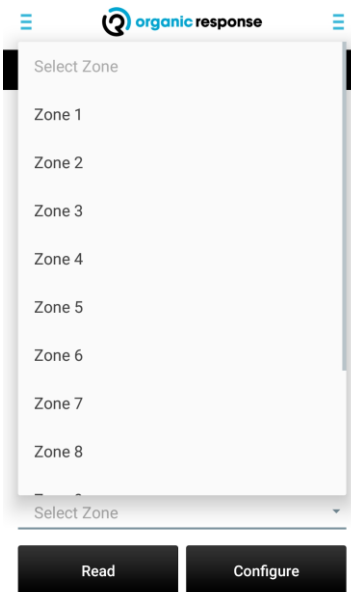

4. Press 'Configure'. The 'Ready to Configure' indicator will pop up.
5. Tap and hold the device next to the switch. It may be necessary to move the android device around to align the device's NFC module to the switch.
6. On success, the app will momentarily indicate 'Done!' with sound notification.
7. Once configured you can make changes by clicking on those functions assigned to any button.

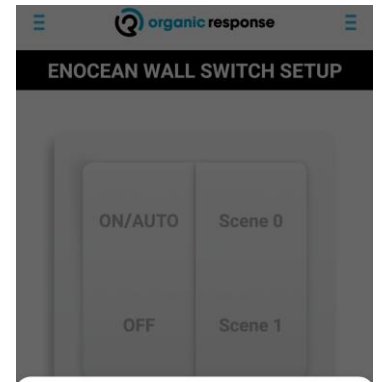

Ready to Configure



Tap and hold your phone next to the wall switch

Reading the Current Configuration:

The current configuration defined by the previous configuration settings can also be read by following the procedure below.

Procedure:

1. With the 'EnOcean Wall Switch Setup' page, press the 'Read' button. The 'Ready to Read' indicator will pop up.
2. Tap and hold the device next to the switch. It may be necessary to move the android device around to align the device's NFC module to the switch.
3. On success, the app will momentarily indicate 'Done' with sound notification. The buttons and zone will get populated with the configured settings.

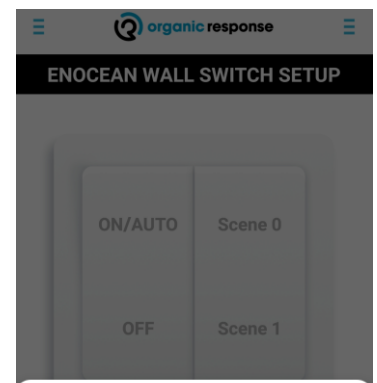

Ready to Read



Tap and hold your phone next to the wall switch

Subject to change without notice. Please contact OR Technologies for further details or most recent versions.